

Museum Collections

資料のご紹介

Please note that exhibits are rotated. There are periods that some collections are not on exhibition.

Collection of Tsuchiya Clan, the ruling family of Tsuchiura Domain

土浦藩土屋家の文化

The museum owns 83 swords of Tsuchiya clan that include 1 National Treasure, 4 Important Cultural Properties, and 6 Important Arts.

The swords collection of Masanao, the 2nd lord of the Tsuchiyas, includes awards and gifts from the shogun and other daimyo families. The noted swords of collection during Masanao's day symbolized the greatness of Tsuchiura domain (95,000 koku in scale), and had been treasured by successive lords as heirlooms.

Although the Meiji Restoration brought a large loss of daimyo families' treasures, it is highly appreciated that the Tsuchiyas' swords have been passed down altogether. (The swords are displayed while rotating contents; National Treasure and Important Cultural property plan to be exhibited in October.)

Kazunao and Masanao, the 1st and the 2nd lords of Tsuchiya clan of Tsuchiura domain were well known as fanciers of tea ceremony. Tsuchiya clan's tea thing collections recorded in the list, called 'Tsuchiya Kura-cho'; the Tsuchiyas book of tea things collection, are famous among antiquaries.



National Treasure Tantō and koshirae

Miniatures of pagoda and temple excavated from Nejika kita ruins

根鹿北遺跡出土瓦塔・瓦堂

The remains of Buddhism building are identified at Nejika Kita site in Imaizumi, Tsuchiura city during Heian period (9th century). It is inferred by excavated materials that the building had placed statues of pagoda and temple which were made of darkish hard-clay similar to texture of roof-tile. By referring to temple architecture in those days and other excavated articles, these pagoda and temple were restored.



Sutra vessel at sutra mound of Tojo-ji temple

東城寺経塚の経筒

12 sutra mounds constructed in Heian period were identified at the back hill of Tojo-ji temple in Tojoji, Tsuchiura city. A sutra vessel was excavated from the mounds, that TAIRA no Munemoto who had strong political power in this region buried in the 12th century. It also offers an opportunity to find ancient religious belief, and who and when buried. (Replicas)

Materials Related to Clansmen of Tsuchiura Domain

土浦藩士関係資料

With various materials, this display features clansmen of varied attainments in Tsuchiura domain including the Seki Family that instructed gunnery, Saisuke Yamamura, a geographer (Dutch scholar), and Tosui Okabe, a retained painter. Video is available to understand their footsteps.

Umbrella-style Folding Globe

大輿地球儀(傘式地球儀)

Created by a local scholar, Bokusen Numajiri, the globe is made of bamboo covered with map printed on Japanese paper. The name comes from foldable structure that looks like umbrellas.

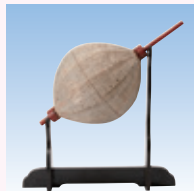

Takase-bune Model

高瀬船模型

The model of Takase-bune awaits you at the entrance. Takase-bune was widely used cargo boats for transportation on Lake Kasumigaura from Edo period to Meiji era. The exhibit is constructed by a shipwright in Tsuchiura. Takase-bune shipped goods which included rice, soy sauce and firewood fuels from Tsuchiura to metropolis Tokyo in Edo period.

American Blue-Eyed Doll

青い目の人形

Blue-eyed dolls, a symbol of goodwill among Japan and America, were distributed to elementary schools and so on across Japan as ambassador dolls in 1927. Most of the dolls were burned and destroyed during the Pacific War since they were 'enemy dolls', coming from an enemy country, but the Tsuchiura kindergarten's doll has been preserved and remained.



Tsuchiura City Museum Information

土浦市立博物館 ごあんない

City museum as a base of history and culture of Tsuchiura

土浦の歴史と文化の発信拠点として

Opened in 1988, Tsuchiura City Museum has provided Tsuchiura-oriented history and culture for visitors.

The 1st floor offers a special section 'Culture of the Tsuchiya clan, the feudal lords of Tsuchiura Domain' where treasures of the Tsuchiya family such as swords and tea utensils are displayed.

Exhibits on the 2nd floor, focused on 'People's Life nurtured by Lake Kasumigaura', introduce visitors to the history of Tsuchiura.

The Museum rotates display items (works) in the exhibition rooms on occasions and holds special exhibitions as well.



Access

交通のご案内

Train

- From West exit of JR Tsuchiura station (take Joban line from Ueno station/70-min. by local, 50-min. by limited express), walk 15-min. or take buses from ④ or ⑤ of bus terminal at West exit, then get off at 'Kijo koen-mae' and walk 1-min..
- From TX Tsukuba station (take Tsukuba express line from Akihabara station/45-min. by express), take buses from ⑤ of bus terminal at Tsukuba bus center, then get off at 'Senzoku-cho' and walk 8-min..

Car

- From Tsuchiura-kita IC of Joban expressway (35-min. drive from Mito IC), drive 10-min.. Or from Sakura-tsuchiura IC (30-min. drive from Misato IC), drive 10-min..

Information

利用のご案内

Open: 9:00am - 5:00pm (admission until 4:30pm)

Closed: Mondays, next day of National Holiday (Open when following day is Saturday/Sunday), and New Year Holiday

Admission fee: Adults ¥105 (¥75), Elementary/junior high/high school students ¥50 (¥30) ;(fee) for group of more than 20 people

Admission fee includes of Tsuchiura City Museum Annex (East Turret)

Admission free for elementary/junior high/high school students on Saturdays

Notice ● Smoking is not allowed on museum property (inside and outside as well)

● Eating and drinking are not allowed. Please be careful not to bother other visitors.

● Please do not touch the exhibits. For photography or videos in the museum, please contact museum reception in advance.



Tsuchiura City Museum

1-5-18, Chuo, Tsuchiura city, Ibaraki prefecture

TEL : 029-824-2928 FAX : 029-824-9423

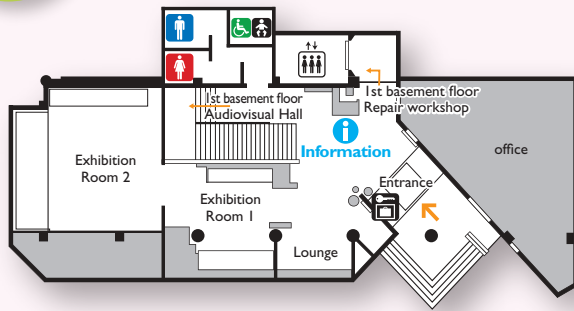
1F

Exhibition Room 1 展示室 1

The exhibits in this Room introduce visitors to the world of 'Culture of the Daimyo (feudal lord) Tsuchiya Clan', the ruling family of the Tsuchiura domain. There are properties including swords and tea utensils which used to be owned by the Tsuchiya family. Swords, designated as National treasure and Important cultural properties, are open to the public in fall every year.



Exhibition Room 2 展示室 2

This Room holds some special exhibitions on different themes. Collections are exhibited according to the theme 'Culture of the Tsuchiya Clan' as with Exhibition Room 1, except the periods of the special exhibitions.

Entrance Hall エントランス

On display are large cylindrical firework-launchers, a scale model of Takase-bune vessel made by a local shipwright and projected images.



Outdoor Exhibits 屋外展示

There are old signposts (designated cultural properties of the city) and foundation stones of Tsuchiura Castle displayed on the outer space of the museum. The garden exhibits can be seen on the 2nd Floor verandah.

2F

Exhibition Hall 展示ホール

Visitors can enjoy hands-on exhibits such as old-day tools, and history quizzes.

Workshops that offer participants to experience weaving can be held here. Information library and reference books help visitors do inquiry-based learning.



Exhibition Room 3 展示室 3

Associated with the main theme 'People's life nurtured by Lake Kasumigaura', the exhibits of this room show visitors actual materials and messages. The display is substituted 4 times a year, therefore new exhibits keep visitors interested in returning to find something new. Special exhibition can be also held here.



Message-Display メッセージ展示

Through short sentences, charts, videos and models, visitors can see characteristics of each era or society from a unique point of view. The main feature of this corner is local stories of 'People's life nurtured by Lake Kasumigaura'.

Actual objects display 実物資料展示

Actual materials are displayed in the showcase. Exhibition materials are subject to change corresponding to new museum collections and research outcome.